

Wall System

- WSCP1384** Center Panel (1 per ctn.)
- WSEP1384** End Panels (2 per ctn.)
- WSS30** Wall System Shelves (2 per ctn.)
- WSS36** Wall System Shelves (2 per ctn.)
- WSS60** Wall System Shelves (2 per ctn.)
- WSTB30** Top/Bottom (2 per ctn.)
- WSTB36** Top/Bottom (2 per ctn.)

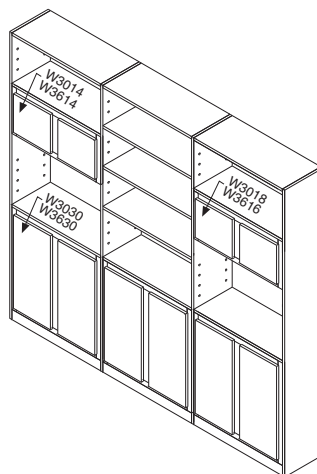
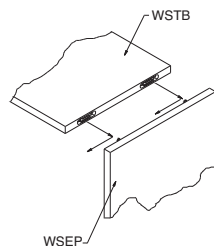

Panel	Description	Size (T x W x H)	Edge Finish	Color Side 1	Color Side 2	Finish
WSCP1384	Center Panel	3/4" x 13" x 84"	1 Long	Exterior	Exterior	Veneer
WSEP1384	End Panels	3/4" x 13" x 84"	1 Long	Exterior	Exterior	Veneer
WSS30	Wall System Shelves	3/4" x 13" x 30"	1 Long	Exterior	Exterior	Veneer
WSS36	Wall System Shelves	3/4" x 13" x 36"	1 Long	Exterior	Exterior	Veneer
WSS60	Wall System Shelves	3/4" x 13" x 60"	1 Long	Exterior	Exterior	Veneer
WSTB30	Top/Bottom	3/4" x 13" x 30"	1 Long	Exterior	Exterior	Veneer
WSTB36	Top/Bottom	3/4" x 13" x 36"	1 Long	Exterior	Exterior	Veneer

Bookshelf Kit

BKSHELFKIT *

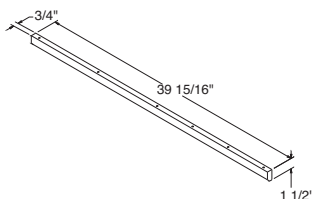

NOTES ✓

- ▶ Recommended for use with Bookcase units where loads on shelves will exceed over 60 lbs.
 - ▶ One Shelf Kit required per shelf.
 - ▶ When ordered in a Rustic Birch style, will not feature rustic characteristics.
- ★Order under door style number.

NOTES ✓

- ▶ AC2417.5 is designed to be used between countertop and Diagonal Wall cabinet.
- ▶ AC2417.5 opening – 12" W x 14.5" H.
- ▶ ACS1817.5 opening – 13" W x 14.5" H.
- ▶ ACS2417.5 opening – 19" W x 14.5" H.
- ▶ ACS3017.5 opening – 25" W x 14.5" H.



Appliance Centers

Under Wall Cabinet Accessory

- AC2417.5** Appliance Center, Diagonal
- ACS1817.5** Appliance Center, Straight
- ACS2417.5** Appliance Center, Straight
- ACS3017.5** Appliance Center, Straight

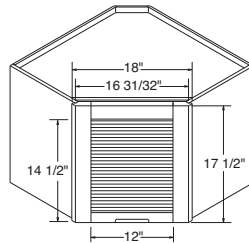

AC2417.5
DIAGONAL

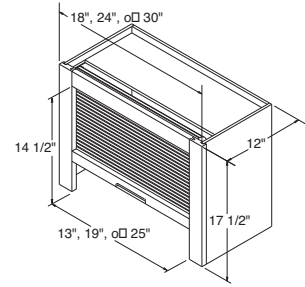

ACS1817.5-ACS3017.5
STRAIGHT

NOTES ✓

- ▶ Designed to be mounted underneath a standard Wall cabinet.
- ▶ SGH30 holds 7 rows.
- ▶ SGH36 holds 9 rows.



Stem Glass Holders

Under Wall Cabinet Accessory

- SGH30**
- SGH36**

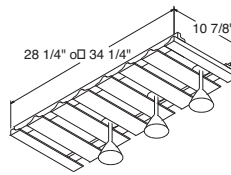

SIDE VIEW

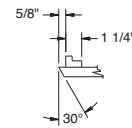

NOTES ✓

- ▶ Designed to mount underneath Wall cabinet.
- ▶ Top, bottom, and sides are finished.



Organizer Shelves

Under Wall Cabinet Accessory

- ORG24**

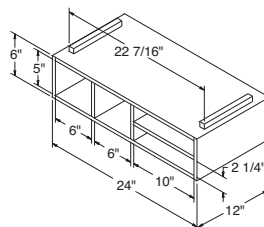

- ORG30**

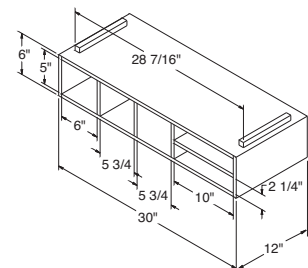

Continued on next page.

Organizer Shelves (continued)

Under Wall Cabinet Accessory

ORG36

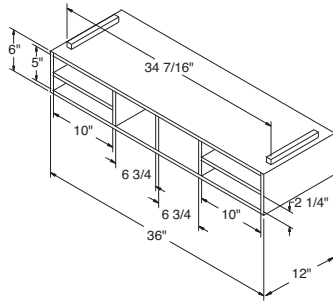

NOTES ✓

- ▶ Designed to mount underneath Wall cabinet.
- ▶ Top, bottom, and sides are finished.



Stem Glass Holders

Wall Open Cabinet Accessory

SGH18
SGH21

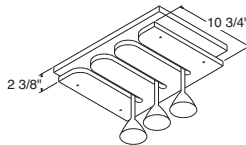

NOTES ✓

- ▶ One 3/4" thick matching Aristex® shelf mounted to each Stem Glass Holder.
- ▶ Stem Glass Holder is installed by placing shelf in position with included shelf clips.
- ▶ SGH18 fits 18" wide Wall cabinets.
- ▶ SGH21 fits 21" wide Wall cabinets.



Wine Caddies

Wall Open Cabinet Accessory

WC18
WC21

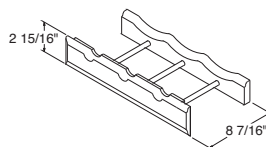

NOTES ✓

- ▶ One 3/4" notched matching Aristex® shelf and four clips included.
- ▶ Wine Caddy rests on shelf and shelf can be adjusted to desired position.
- ▶ WC18 holds three bottles. Fits 18" wide Wall cabinets.
- ▶ WC21 holds four bottles. Fits 21" wide Wall cabinets.



NOTES ✓

- ▶ Will only mount inside of Open Wall cabinets. Cannot be used underneath cabinets.
 - ▶ Apothecary Drawer is mounted in a 1/2" standard laminated case (natural maple color), and comes complete with side-mounted Full-Extension drawer guide system.
 - ▶ One 3/4" notched matching Aristex® shelf included with each Apothecary Drawer to place on top of case to give it a finished look.
 - ▶ Units have a simulated three-panel drawer front except Augusta, Briarcliff, Durham, Ellsworth, and Monroe. Augusta, Ellsworth, and Monroe drawer fronts are slab. Briarcliff and Durham drawer fronts are 5-piece.
 - ▶ Does not include decorative hardware on any style.
 - ▶ Only available in Standard construction (not available as wood dovetail).
 - ▶ APDWR18 fits 18" wide Wall cabinet.
 - ▶ APDWR21 fits 21" wide Wall cabinet.
- ★Order under door style number, not common style number.

Apothecary Drawers

Wall Open Cabinet Accessory

APDWR18 ★
APDWR21 ★

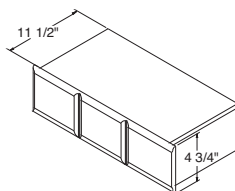

NOTES ✓

- ▶ Designed for use in WOL cabinets.
- ▶ PR18 fits 18" wide Wall cabinet. Holds 8 plates.
- ▶ PR21 fits 21" wide Wall cabinet. Holds 10 plates.
- ▶ Can be easily removed for cleaning.



Plate Racks

Wall Open Cabinet Accessory

PR18
PR21

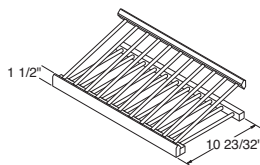

Wall Spice Racks

Wall Cabinet Accessory

- SRD15** Spice Rack, Door Mounted (21 1/4" H x 9 1/2" W)
- SRD18** Spice Rack, Door Mounted (21 1/4" H x 12 1/2" W)
- SRD21** Spice Rack, Door Mounted (21 1/4" H x 15 1/2" W)

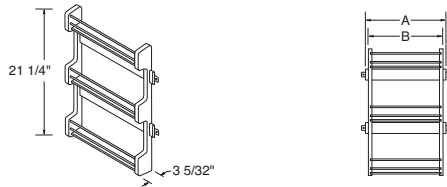

	Recommended for
SRD15	15" or 30" wide
SRD18	18" or 36" wide
SRD21	21" or 42" wide

	A dimension	B dimension
SRD15	10 1/2"	9 1/2"
SRD18	13 1/2"	12 1/2"
SRD21	16 1/2"	15 1/2"

NOTES ✓

- ▶ Natural wood finish with chrome bars.
- ▶ Designed for Wall cabinets (30", 36", and 42" high), Base cabinets, Utility cabinets, and Linen Closet cabinets. Make sure to avoid interference with roll trays, full depth shelves, or other interior cabinet accessories.
- ▶ Mounts to door frame.
- ▶ Order under style #010.

DESIGN SOLUTIONS

- ▶ Great for use in the bathroom to hold vitamins, medications, etc.



Pegged Dish Organizer

Drawer Accessory

PDO
PDOPOSTS

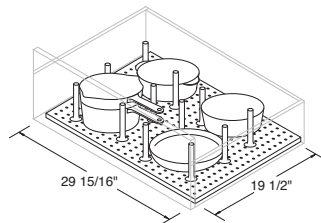

NOTES ✓

- ▶ PDO includes 8 wooden posts and board.
- ▶ PDOPOSTS includes 4 wooden posts.
- ▶ Pegged board is 3/8" thick.
- ▶ Recommended for use in DB36. Pegged board can be trimmed for use in smaller applications.
- ▶ Order under style #010.



Drawer Spice Racks

Drawer Accessory

- SR12** 6 27/32" Wide x 19 15/16" Deep (Trimnable Depth to 18 15/16" for PABD)
- SR15** 9 27/32" Wide x 19 15/16" Deep (Trimnable Depth to 18 15/16" for PABD)
- SR18** 12 27/32" Wide x 19 15/16" Deep (Trimnable Depth to 18 15/16" for PABD)
- SR21** 15 27/32" Wide x 19 15/16" Deep (Trimnable Depth to 18 15/16" for PABD)
- SR24** 18 27/32" Wide x 19 15/16" Deep (Trimnable Depth to 18 15/16" for PABD)

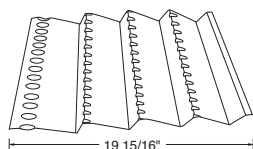

NOTES ✓

- ▶ White plastic tiered rack with notches to help keep spices from rolling.
- ▶ Depth is 19 15/16" to fit a dovetail drawer and can be easily trimmed with no cutting to 18 15/16" to fit a furniture board drawer.
- ▶ Dishwasher safe.
- ▶ Order under style #010.



NOTES ✓

- ▶ Acrylic Bread Lid Kit.
- ▶ Drawer not included.
- ▶ Order under style #010.
- ▶ BLK units are for standard drawer boxes.
- ▶ UMBLK units are for dovetail drawer boxes.



Bread Lid Kits

Drawer Accessory

- BLK15** Bread Lid Kit
- BLK18** Bread Lid Kit
- BLK21** Bread Lid Kit
- BLK24** Bread Lid Kit
- UMBLK15C** Undermount Bread Lid Kit (for 3/4" Dovetail Drawer)
- UMBLK18C** Undermount Bread Lid Kit (for 3/4" Dovetail Drawer)
- UMBLK21C** Undermount Bread Lid Kit (for 3/4" Dovetail Drawer)
- UMBLK24C** Undermount Bread Lid Kit (for 3/4" Dovetail Drawer)

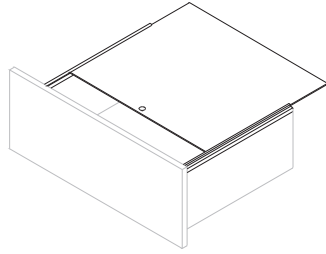

NOTES ✓

- ▶ Cutlery Trays are standard on Drawer Base cabinets 15"-24" wide.
- ▶ All Cutlery Trays are white and 2" high.
- ▶ CT__ depth is 18 15/16" (for 20" deep furniture board drawers).
- ▶ CT__UM depth is 19 9/16" (for 21" deep undermount dovetail drawers).
- ▶ Order under style #010.



Cutlery Trays

Drawer Accessory

- CT15** Cutlery Tray 15", Plastic
- CT15UM** Cutlery Tray 15", Plastic
- CT18** Cutlery Tray 18", Plastic
- CT18UM** Cutlery Tray 18", Plastic
- CT21** Cutlery Tray 21", Plastic
- CT21UM** Cutlery Tray 21", Plastic
- CT24** Cutlery Tray 24", Plastic
- CT24UM** Cutlery Tray 24", Plastic

	Width	Depth
CT15	9 27/32"	18 15/16"
CT15UM	9 15/16"	19 9/16"
CT18	12 27/32"	18 15/16"
CT18UM	12 15/16"	19 9/16"
CT21	15 27/32"	18 15/16"
CT21UM	15 15/16"	19 9/16"
CT24	18 27/32"	18 15/16"
CT24UM	18 15/16"	19 9/16"

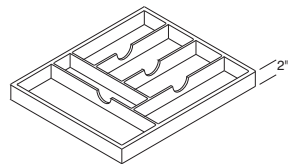

Cutting Board Kit

Drawer Accessory

CBK *

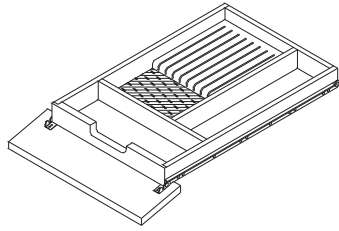

CUTLERY KIT

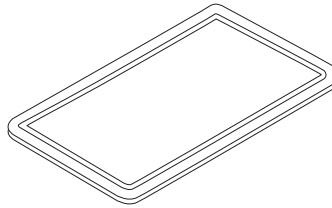

CUTTING BOARD

NOTES ✓

- ▶ CBK contains Cutlery Drawer, drawer front, drawer frame assembly, and Cutting Board.
- ▶ CBK can be field installed for B18, B36, and DB18. Not compatible with B36B.

*Order under door style number.



Doors Cut For Glass

DCFG†

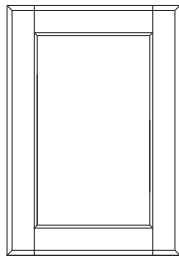

† Durham, Ellsworth, and Monroe are only available in WPG sizes.

NOTES ✓

- ▶ Cabinet not included. Must be ordered separately.
- ▶ Not available in Nantucket or Augusta.
- ▶ Order Teagan doors as Winstead.
- ▶ Glass is not included. See Parts Book for specifications and pricing.
- ▶ Not available on Utility and LCD cabinet tall doors.
- ▶ Doors prepared for insert by customer.

Glass Shelf Kits, 12" Deep

- GSK1512
- GSK1812
- GSK2112
- GSK2412
- GSK2712
- GSK3012
- GSK3312
- GSK3612

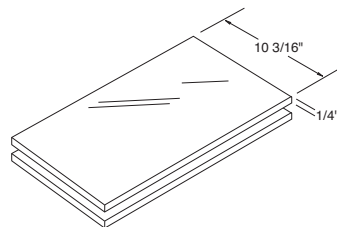

NOTES ✓

- ▶ Meets KCMA standards of 15 lbs. per square foot.
- ▶ Cannot be trimmed.
- ▶ Kit includes two 1/4" thick tempered glass shelves and shelf clips.
- ▶ Order under style #010.



NOTES ✓

- ▶ Meets KCMA standards of 15 lbs. per square foot.
- ▶ Cannot be trimmed.
- ▶ Kit includes two 1/4" thick tempered glass shelves and shelf clips.
- ▶ Order under style #010.



Glass Shelf Kits, Diagonal

GSKDC24
GSKDC27

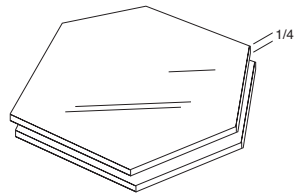

GSKDC24 (FITS DC...24)

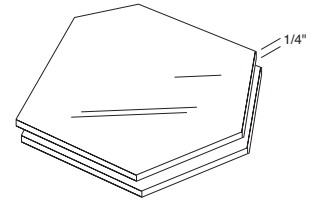

GSKDC27 (FITS DC...27)

NOTES ✓

- ▶ Sold in pairs.
- ▶ Used to deflect heat from self-cleaning ovens, away from cabinet doors and drawer fronts.
- ▶ Includes installation screws.
- ▶ White finish.
- ▶ For use on cabinets next to an oven/range when an additional 1/8" cannot be added to the oven manufacturer's recommended space requirement between the oven and each adjacent cabinet.
- ▶ Cabinet door cannot be hinged on the same side as the angled heat shield, not compatible with double door cabinets.
- ▶ Installs on the front of the face frame of each cabinet adjacent to the oven.

Heat Shield, Angled

HEATSHIELDAN *New!*

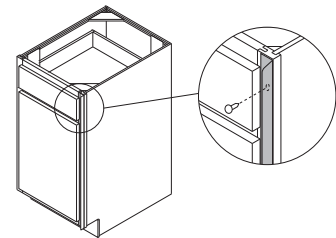
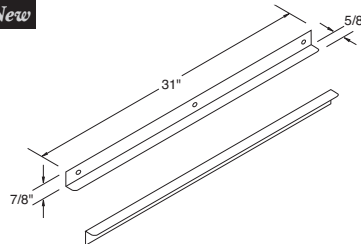

Heat Shield, Straight

HEATSHIELDST *New*

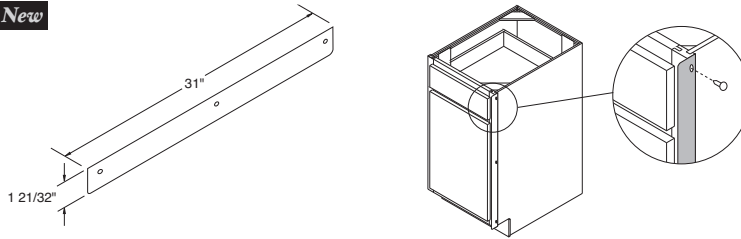

NOTES ✓

- ▶ Sold in pairs.
- ▶ Used to deflect heat from self-cleaning ovens, away from cabinet doors and drawer fronts.
- ▶ Includes installation screws.
- ▶ White finish.
- ▶ For use on cabinets next to an oven/range when an additional 1/8" can be added to the oven manufacturer's recommended space requirement.
- ▶ Installs on the side of the face frame of each cabinet adjacent to the oven.

Oven Installation Kit

OCINSTALLKIT

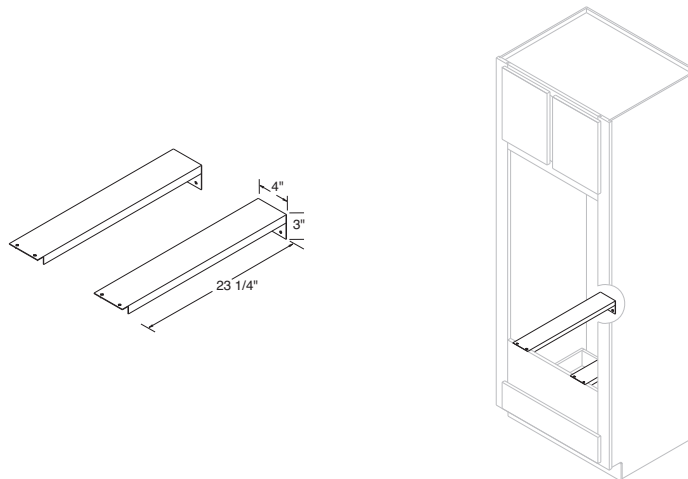

NOTES ✓

- ▶ Two metal brackets to support ovens and microwaves.
- ▶ Designed to be used with OC and OCD cabinets.
- ▶ Cabinet not included.
- ▶ Order under style #010.



NOTES

- ▶ Pantry Shelf Kits contain four shelves and sixteen clips.
- ▶ Maximum weight per square foot is 15 lbs.
- ▶ Pantry Shelf Kits are natural maple laminate or specify PKS_ _WH for white.
- ▶ Order under style #010.
- ▶ SKU Reference List
 - SKU without C = 1/2" thick
Ex. PKS_ _
 - SKU with C = 3/4" thick
Ex. PKS_ _C
 - SKU with WH = white
Ex. PKS_ _WH
 - SKU with PL = plywood
Ex. PKS_ _PL
 - SKU with 12 = 12" deep
Ex. PKS_ _12

1/2" Thick
3/4" Thick



ACCESSORIES AND PARTS

Pantry Shelf Kits

PKS15	Pantry Shelf Kit (13 1/2" x 22 1/2"-1/2" thick, natural maple laminate, fits 24" deep)
PKS15WH	Pantry Shelf Kit (13 1/2" x 22 1/2"-1/2" thick, white laminate, fits 24" deep)
PKS18	Pantry Shelf Kit (16 1/2" x 22 1/2"-1/2" thick, natural maple laminate, fits 24" deep)
PKS18WH	Pantry Shelf Kit (16 1/2" x 22 1/2"-1/2" thick, white laminate, fits 24" deep)
PKS24	Pantry Shelf Kit (22 1/2" x 22 1/2"-1/2" thick, natural maple laminate, fits 24" deep)
PKS24WH	Pantry Shelf Kit (22 1/2" x 22 1/2"-1/2" thick, white laminate, fits 24" deep)
PKS1512	Pantry Shelf Kit (13 1/2" x 10 11/32"-1/2" thick, natural maple laminate, fits 12" deep)
PKS1512WH	Pantry Shelf Kit (13 1/2" x 10 11/32"-1/2" thick, white laminate, fits 12" deep)
PKS1812	Pantry Shelf Kit (16 1/2" x 10 11/32"-1/2" thick, natural maple laminate, fits 12" deep)
PKS1812WH	Pantry Shelf Kit (16 1/2" x 10 11/32"-1/2" thick, white laminate, fits 12" deep)
PKS2412	Pantry Shelf Kit (22 1/2" x 10 11/32"-1/2" thick, natural maple laminate, fits 12" deep)
PKS2412WH	Pantry Shelf Kit (22 1/2" x 10 11/32"-1/2" thick, white laminate, fits 12" deep)
PKS15C	Pantry Shelf Kit (13 1/2" x 22 1/2"-3/4" thick, natural maple laminate, fits 24" deep)
PKS15CWH	Pantry Shelf Kit (13 1/2" x 22 1/2"-3/4" thick, white laminate, fits 24" deep)
PKS18C	Pantry Shelf Kit (16 1/2" x 22 1/2"-3/4" thick, natural maple laminate, fits 24" deep)
PKS18CWH	Pantry Shelf Kit (16 1/2" x 22 1/2"-3/4" thick, white laminate, fits 24" deep)
PKS24C	Pantry Shelf Kit (22 1/2" x 22 1/2"-3/4" thick, natural maple laminate, fits 24" deep)
PKS24CWH	Pantry Shelf Kit (22 1/2" x 22 1/2"-3/4" thick, white laminate, fits 24" deep)
PKS30C	Pantry Shelf Kit (28 1/2" x 22 1/2"-3/4" thick, natural maple laminate, fits 24" deep)
PKS30CWH	Pantry Shelf Kit (28 1/2" x 22 1/2"-3/4" thick, white laminate, fits 24" deep)
PKS36C	Pantry Shelf Kit (34 1/2" x 22 1/2"-3/4" thick, natural maple laminate, fits 24" deep)
PKS36CWH	Pantry Shelf Kit (34 1/2" x 22 1/2"-3/4" thick, white laminate, fits 24" deep)
PKS1512C	Pantry Shelf Kit (13 1/2" x 10 11/32"-3/4" thick, natural maple laminate, fits 12" deep)
PKS1512CWH	Pantry Shelf Kit (13 1/2" x 10 11/32"-3/4" thick, white laminate, fits 12" deep)
PKS1812C	Pantry Shelf Kit (16 1/2" x 10 11/32"-3/4" thick, natural maple laminate, fits 12" deep)
PKS1812CWH	Pantry Shelf Kit (16 1/2" x 10 11/32"-3/4" thick, white laminate, fits 12" deep)
PKS2412C	Pantry Shelf Kit (22 1/2" x 10 11/32"-3/4" thick, natural maple laminate, fits 12" deep)
PKS2412CWH	Pantry Shelf Kit (22 1/2" x 10 11/32"-3/4" thick, white laminate, fits 12" deep)
PKS3012C	Pantry Shelf Kit (28 1/2" x 10 11/32"-3/4" thick, natural maple laminate, fits 12" deep)
PKS3012CWH	Pantry Shelf Kit (28 1/2" x 10 11/32"-3/4" thick, white laminate, fits 12" deep)
PKS3612C	Pantry Shelf Kit (34 1/2" x 10 11/32"-3/4" thick, natural maple laminate, fits 12" deep)
PKS3612CWH	Pantry Shelf Kit (34 1/2" x 10 11/32"-3/4" thick, white laminate, fits 12" deep)
PKS15CPL <i>New</i>	Pantry Shelf Kit (13 1/2" x 22 1/2"-3/4" thick plywood, natural maple laminate, fits 24" deep)
PKS15CWHPL <i>New</i>	Pantry Shelf Kit (13 1/2" x 22 1/2"-3/4" thick plywood, white laminate, fits 24" deep)
PKS18CPL <i>New</i>	Pantry Shelf Kit (16 1/2" x 22 1/2"-3/4" thick plywood, natural maple laminate, fits 24" deep)
PKS18CWHPL <i>New</i>	Pantry Shelf Kit (16 1/2" x 22 1/2"-3/4" thick plywood, white laminate, fits 24" deep)
PKS24CPL <i>New</i>	Pantry Shelf Kit (22 1/2" x 22 1/2"-3/4" thick plywood, natural maple laminate, fits 24" deep)
PKS24CWHPL <i>New</i>	Pantry Shelf Kit (22 1/2" x 22 1/2"-3/4" thick plywood, white laminate, fits 24" deep)
PKS30CPL <i>New</i>	Pantry Shelf Kit (28 1/2" x 22 1/2"-3/4" thick plywood, natural maple laminate, fits 24" deep)
PKS30CWHPL <i>New</i>	Pantry Shelf Kit (28 1/2" x 22 1/2"-3/4" thick plywood, white laminate, fits 24" deep)
PKS36CPL <i>New</i>	Pantry Shelf Kit (34 1/2" x 22 1/2"-3/4" thick plywood, natural maple laminate, fits 24" deep)
PKS36CWHPL <i>New</i>	Pantry Shelf Kit (34 1/2" x 22 1/2"-3/4" thick plywood, white laminate, fits 24" deep)
PKS1512CPL <i>New</i>	Pantry Shelf Kit (13 1/2" x 10 11/32"-3/4" thick plywood, natural maple laminate, fits 12" deep)
PKS1512CWHPL <i>New</i>	Pantry Shelf Kit (13 1/2" x 10 11/32"-3/4" thick plywood, white laminate, fits 12" deep)
PKS1812CPL <i>New</i>	Pantry Shelf Kit (16 1/2" x 10 11/32"-3/4" thick plywood, natural maple laminate, fits 12" deep)
PKS1812CWHPL <i>New</i>	Pantry Shelf Kit (16 1/2" x 10 11/32"-3/4" thick plywood, white laminate, fits 12" deep)
PKS2412CPL <i>New</i>	Pantry Shelf Kit (22 1/2" x 10 11/32"-3/4" thick plywood, natural maple laminate, fits 12" deep)
PKS2412CWHPL <i>New</i>	Pantry Shelf Kit (22 1/2" x 10 11/32"-3/4" thick plywood, white laminate, fits 12" deep)
PKS3012CPL <i>New</i>	Pantry Shelf Kit (28 1/2" x 10 11/32"-3/4" thick plywood, natural maple laminate, fits 12" deep)
PKS3012CWHPL <i>New</i>	Pantry Shelf Kit (28 1/2" x 10 11/32"-3/4" thick plywood, white laminate, fits 12" deep)
PKS3612CPL <i>New</i>	Pantry Shelf Kit (34 1/2" x 10 11/32"-3/4" thick plywood, natural maple laminate, fits 12" deep)
PKS3612CWHPL <i>New</i>	Pantry Shelf Kit (34 1/2" x 10 11/32"-3/4" thick plywood, white laminate, fits 12" deep)

3/4" Thick Plywood



PANTRY SHELF KIT CLIPS

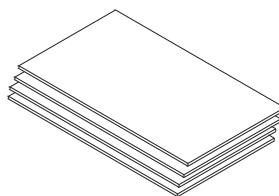

PANTRY SHELF KIT SHELVES

Pantry Roll Out Kits

UPK15	Pantry Roll Out Kit 15" (10 11/16" W x 20 3/16" D x 31 1/8" H)
UPK15WH	Pantry Roll Out Kit 15" (10 11/16" W x 20 3/16" D x 31 1/8" H)
UPK18	Pantry Roll Out Kit 18" (13 11/16" W x 20 3/16" D x 31 1/8" H)
UPK18WH	Pantry Roll Out Kit 18" (13 11/16" W x 20 3/16" D x 31 1/8" H)
UPK24	Pantry Roll Out Kit 24" (19 11/16" W x 20 3/16" D x 31 1/8" H)
UPK24WH	Pantry Roll Out Kit 24" (19 11/16" W x 20 3/16" D x 31 1/8" H)
UPK30	Pantry Roll Out Kit 30" (25 11/16" W x 20 3/16" D x 31 1/8" H)
UPK30WH	Pantry Roll Out Kit 30" (25 11/16" W x 20 3/16" D x 31 1/8" H)
UPK36	Pantry Roll Out Kit 36" (31 11/16" W x 20 3/16" D x 31 1/8" H)
UPK36WH	Pantry Roll Out Kit 36" (31 11/16" W x 20 3/16" D x 31 1/8" H)

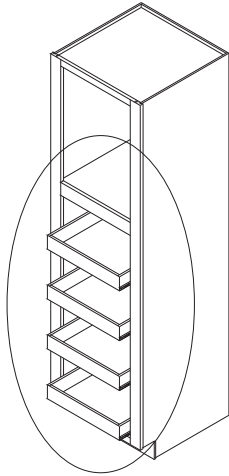

NOTES ✓

- ▶ Pantry Roll Out Kits contain four trays, eight suspension tracks, eight corner standards, and installation screws.
- ▶ Maximum weight per square foot is 15 lbs.
- ▶ Pantry Roll Out Trays cannot be used in any Utility cabinet 12" deep.
- ▶ Order under style #010.

DESIGN SOLUTIONS

- ▶ Shelf or Roll Out Tray Kits can be used to convert a standard Utility cabinet into a Pantry.



Roll Out Kits

TKIT15	Roll Out Tray Kit 15" (fits 12" opening)
TKIT15WH	Roll Out Tray Kit 15" (fits 12" opening)
TKIT18	Roll Out Tray Kit 18" (fits 15" opening)
TKIT18WH	Roll Out Tray Kit 18" (fits 15" opening)
TKIT21	Roll Out Tray Kit 21" (fits 18" opening)
TKIT21WH	Roll Out Tray Kit 21" (fits 18" opening)
TKIT24	Roll Out Tray Kit 24" (fits 21" opening)
TKIT24WH	Roll Out Tray Kit 24" (fits 21" opening)
TKIT27	Roll Out Tray Kit 27" (fits 24" opening)
TKIT27WH	Roll Out Tray Kit 27" (fits 24" opening)
TKIT30	Roll Out Tray Kit 30" (fits 27" opening)
TKIT30WH	Roll Out Tray Kit 30" (fits 27" opening)
TKIT33	Roll Out Tray Kit 33" (fits 30" opening)
TKIT33WH	Roll Out Tray Kit 33" (fits 30" opening)
TKIT36	Roll Out Tray Kit 36" (fits 33" opening)
TKIT36WH	Roll Out Tray Kit 36" (fits 33" opening)
TKIT39	Roll Out Tray Kit 39" (fits 16 1/2" opening)
TKIT39WH	Roll Out Tray Kit 39" (fits 16 1/2" opening)
TKIT45	Roll Out Tray Kit 45" (fits 19 1/2" opening)
TKIT45WH	Roll Out Tray Kit 45" (fits 19 1/2" opening)

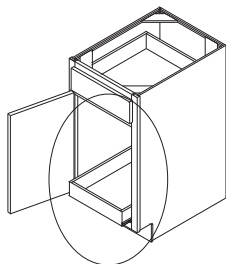

NOTES ✓

- ▶ TKIT15/TKIT15WH-TKIT36/TKIT36WH Contain: One tray, two track slides, two mounting blocks, two 2 1/2" wood screws, four 5/8" wood screws, and two 1/8" spacers.
- ▶ TKIT39/TKIT39WH & TKIT45/TKIT45WH Contain: two trays, four track slides, four mounting blocks, two 2 1/2" wood screws, eight 5/8" wood screws, and two 1/8" spacers.
- ▶ Roll Trays feature 1/2" thick solid wood front and furniture board sides and back, or specify TKIT_ _WH for white.
- ▶ Maximum weight per square foot is 15 lbs.
- ▶ All guides are white.
- ▶ Order under style #010.
- ▶ No TKIT available for B27 due to face frame.
- ▶ See Storage Accessories Matrix on pages 192 & 193.

DESIGN SOLUTIONS

- ▶ An additional Roll Out Tray can be installed above the Base cabinet half-depth shelf.



NOTES ✓

- ▶ Includes two bumpers, two screws.
- ▶ Use to protect door from Roll Tray corner.
- ▶ Order under style #010.



Roll Tray Bumper Pads

RTBP

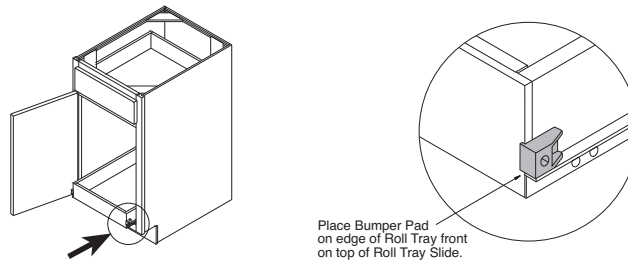

NOTES ✓

- ▶ White epoxy coated wire with Full Extension guides.
- ▶ Includes two 27 quart Wastebaskets with wire storage compartment.
- ▶ Mounted on white melamine board and installs to floor of cabinet.
- ▶ Order under style #010.

★ Fits 15" wide Base cabinet. Installation of this accessory requires removing half-depth shelf. See matrix on pages 192 & 193 for installation recommendations.



Double Wastebasket Roll Out

DWBR ★

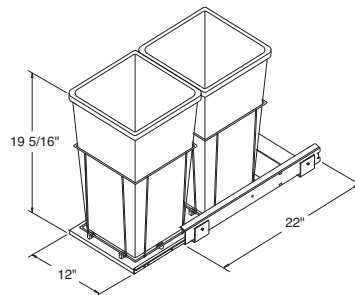

Sink Tip-Out Trays

NOTES ✓

- ▶ Pulls to add to the false front must be ordered separately.
- ▶ If STOTs are used on a full overlay style, it is recommended that a Pull be used.
- ▶ STOT30WH & STOT36WH are for cabinets with two false fronts.
- ▶ STOT30WHB & STOT36WHB are for cabinets with one false front.
- ▶ 2 1/4" deep.
- ▶ Order under style #010.
- ▶ See Storage Accessory Matrix on pages 192 & 193.



- STOT30WH** Sink (tip-out) Tray 30" (two 11½" trays, 4 hinges) White
- STOT36WH** Sink (tip-out) Tray 36" (two 14½" trays, 4 hinges) White
- STOT30WHB *New*** Sink (tip-out) Tray 30" (two 11½" trays, 2 hinges) White
- STOT36WHB *New*** Sink (tip-out) Tray 36" (two 14½" trays, 2 hinges) White

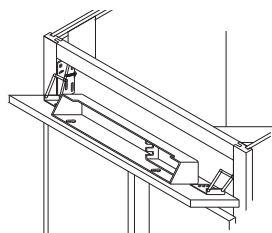

Smart Stop Door Mechanism

SSDM

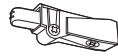

NOTES ✓

- ▶ Creates a smooth and silent closing motion.
- ▶ Recommended usage per cabinet: 1 per door on any door with 2 hinges and 2 per door on any door with 3 or more hinges. Additional units may be required when an accessory item is attached to the cabinet door.
- ▶ Not recommended for use on bi-fold doors or Base SuperCabinets™.

Hinges

HINGEADJ
HINGE6WAY

NOTES ✓

- ▶ HINGEADJ is used on 7/16" overlay door styles (except butt door applications).
- ▶ HINGE6WAY is used on full overlay door styles and butt door applications of 7/16" overlay door styles.
- ★Order under door style number.

Stain, Toner, and Touch-Up

STAINPT Pint of Stain
STAINQT Quart of Stain
TONERPT Pint of Toner
TUKIT * Touch-Up Kit
TUPSTICK ** Touch-Up Stick
TUPSPRAY Touch-Up Spray Can

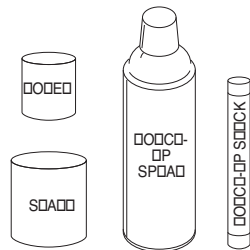

NOTES ✓

- ▶ Order 1 pint of Toner for 1 quart of Stain.
- ▶ For white and antique styles, Touch-Up is only recommended for face frames and End Panels.
- ▶ Use Maple/Birch for Rustic finishes.
- ★Touch-Up Kit contains one felt marker and one putty stick.
- ★★Touch-Up Stick – when ordering TUPSTICK, a single putty stick in the selected color is sent.

Wood Type	Color	Style #	Toner	Stain/Glaze
Oak	Natural	•	–	–
Oak	Wheat	186	–	Wheat
Oak	Spice	185	Spice	Spice
Oak	Saddle	171	Saddle	Saddle
Oak	Sarsaparilla	187	Sarsaparilla	Sarsaparilla
Maple/Birch	Fawn	197	Fawn	–
Maple/Birch	Autumn	183	Autumn	Autumn
Maple	Natural	•	–	–
Maple/Birch	Rouge	180	Rouge	Rouge
Maple/Birch	Cocoa	179	Glaze Toner	Cocoa Glaze
Maple/Birch	Saddle	170	Saddle	Saddle
Maple	Java	168	Glaze Toner	Java Glaze
Maple	Sarsaparilla	193	Sarsaparilla	Sarsaparilla
Thermofoil	White	•	–	–
Thermofoil	Antique	•	–	–
PureStyle™ Laminate	Toasted Antique	•	–	–
Hickory	Natural	•	–	–
Hickory	Wheat	177	–	Wheat
Hickory	Saddle	172	Saddle	Saddle
Cherry	Cognac	195	Cognac	Cognac
Cherry	Wheat	176	–	Wheat
Cherry	Cocoa	175	Glaze Toner	Cocoa Glaze
Cherry	Rouge	174	Rouge	Rouge
Cherry	Saddle	173	Saddle	Saddle
Cherry	Java	169	Glaze Toner	Java Glaze

TRADITIONAL STORAGE ACCESSORY MATRIX

Cabinet	Double Wastebasket Roll Out	STOT30WH Sink Tip-Out Tray 30" Two 11 1/2" trays, 4 hinges	STOT30WHB Sink Tip-Out Tray 30" Two 11 1/2" trays, 2 hinges	STOT36WH Sink Tip-Out Tray 36" Two 14 1/2" trays, 4 hinges	STOT36WHB Sink Tip-Out Tray 36" Two 14 1/2" trays, 2 hinges	Roll Out Kit**
B12	•	•	•	•	•	•
B15	H *	•	•	•	•	TKIT15
B15RT	•	•	•	•	•	TKIT15
B18	H	•	•	•	•	TKIT18
B18RT	•	•	•	•	•	TKIT18
B21	H	•	•	•	•	TKIT21
B21RT	•	•	•	•	•	TKIT21
B24	H	•	•	•	•	TKIT24
B24RT	•	•	•	•	•	TKIT24
B24DD	H	•	•	•	•	TKIT24
B24DDRT	•	•	•	•	•	TKIT24
B27	•	•	•	•	•	•
B27B	•	•	•	•	•	TKIT27
B27RT	•	•	•	•	•	TKIT27
B27RTB	•	•	•	•	•	TKIT27
B30	H *	•	•	•	•	TKIT15
B30B	H	•	•	•	•	TKIT30
B30RT	•	•	•	•	•	TKIT30
B30RTB	•	•	•	•	•	TKIT30
B33	H	•	•	•	•	•
B33B	H	•	•	•	•	TKIT33
B33RT	•	•	•	•	•	TKIT33
B33RTB	•	•	•	•	•	TKIT33
B36	H	•	•	•	•	TKIT18
B36B	H	•	•	•	•	TKIT36
B36RT	•	•	•	•	•	TKIT36
B36RTB	•	•	•	•	•	TKIT36
B39	H	•	•	•	•	•
B39RT	•	•	•	•	•	TKIT39
B42	H	•	•	•	•	TKIT21
B42RT	•	•	•	•	•	TKIT21
B45	H	•	•	•	•	TKIT45
B45RT	•	•	•	•	•	TKIT45
B48	H	•	•	•	•	TKIT24
B48RT	•	•	•	•	•	TKIT24
B15FH	I *	•	•	•	•	TKIT15
B18FH	I	•	•	•	•	TKIT18
B21FH	I	•	•	•	•	TKIT21
B24FH	I	•	•	•	•	TKIT24
B30FH	I *	•	•	•	•	TKIT15
B30FHB	I	•	•	•	•	TKIT30
B36FH	I	•	•	•	•	TKIT18
B36FHB	I	•	•	•	•	TKIT36
BWB15FH	•	•	•	•	•	•
BWB18	•	•	•	•	•	•
BWB21	•	•	•	•	•	•
SCB36	•	•	•	•	•	•
SCB39	H	•	•	•	•	•
SCB42	H	•	•	•	•	•
SCB45	H	•	•	•	•	•
SCB48	H	•	•	•	•	TKIT21
SCER36	•	•	•	•	•	•
SB24	P	I †	•	I †	•	TKIT24
SB24DD	P	I †	•	I †	•	TKIT24
SB27	P	I †	•	I †	•	TKIT27
SB27B	P	I †	•	•	•	TKIT27
SB30	P	I *	•	•	•	TKIT15
SB30B	P	•	I *	•	•	TKIT30

NOTES ✓

KEY

- F** Must remove full-depth shelf.
- H** Must remove half-depth shelf.
- I** Can be installed without modification to cabinet.
- P** Location of plumbing should be checked prior to installation of storage accessory.
- *** Recommended.
- Not applicable.
- †** Only one tray will fit.
- **** Roll Out Kits also available in white, specify TKIT_ _WH.

TRADITIONAL STORAGE ACCESSORY MATRIX

Cabinet	Double Wastebasket Roll Out	STOT30WH Sink Tip-Out Tray 30" Two 11 1/2" trays, 4 hinges	STOT30WHB Sink Tip-Out Tray 30" Two 11 1/2" trays, 2 hinges	STOT36WH Sink Tip-Out Tray 36" Two 14 1/2" trays, 4 hinges	STOT36WHB Sink Tip-Out Tray 36" Two 14 1/2" trays, 2 hinges	Roll Out Kit**
SB33	P		•	•	•	•
SB33B	P	•	*	•	•	TKIT33
SB36	P		•	*	•	TKIT18
SB36B	P	•		•	*	TKIT36
SB39	P		•		•	TKIT39
SB42	P		•		•	TKIT21
SB45	P		•		•	TKIT45
SB48	P		•		•	TKIT24
SBDC36	P	†	•	†	•	•
SBDC42	P	†	•	†	•	•
CNTYSB30	•	•	•	•	•	TKIT15
CNTYSB30B	•	•	•	•	•	TKIT30
CNTYSB36	•	•	•	•	•	TKIT18
CNTYSB36B	•	•	•	•	•	TKIT36
SF30 (POL)	P	†	•	†	•	•
SF30 (FOL)	P		•	•	•	•
SF36 (POL)	P	*	•	•	•	•
SF36 (FOL)	P		•	*	•	•
SF36B (POL)	P	•		•	•	•
SF36B (FOL)	P	•		•	*	•
SF42	P		•	*	•	•
SF48	P		•		•	•
SFC36	P	†	•	•	•	•
SFC42	P	†	•	†	•	•
PB18	F	•	•	•	•	•
PB24	F	•	•	•	•	•
PB24DD	F	•	•	•	•	•
PB30	F	•	•	•	•	•
PB30B	F	•	•	•	•	•
PB36	F	•	•	•	•	•
PB36B	F	•	•	•	•	•
PB42	F	•	•	•	•	•
PB48	F	•	•	•	•	•
PBSC27	F	•	•	•	•	•
PBSC27B	F	•	•	•	•	•
PBSC42	F	•	•	•	•	•
PBSC48	F	•	•	•	•	•
U15/U1590/U1596		•	•	•	•	TKIT15
U18/U1890/U18596		•	•	•	•	TKIT18
U24/U2490/U2496		•	•	•	•	TKIT24
U30/U3090/U3096		•	•	•	•	TKIT15
U30B/U3090B/U3096B		•	•	•	•	TKIT30
U36/U3696/U3696		•	•	•	•	TKIT18
U36B/U3696B/U3696B		•	•	•	•	TKIT36
B24DDFHUDB		•	•	•	•	TKIT24
B30FHUDB		•	•	•	•	TKIT15
B30FHUDB		•	•	•	•	TKIT30
B33FHUDB		•	•	•	•	•
B33FHUDB		•	•	•	•	TKIT33
B36FHUDB		•	•	•	•	TKIT18
B36FHUDB		•	•	•	•	TKIT36
SB30UD	•	*	•	•	•	TKIT30
SB30UDB	•	•	*	•	•	TKIT30
SB36UD	•		•	*	•	TKIT36
SB36UDB	•	•		•	*	TKIT36
U18UD		•	•	•	•	TKIT18
U24UD		•	•	•	•	TKIT24

NOTES ✓

KEY

- F** Must remove full-depth shelf.
- H** Must remove half-depth shelf.
- I** Can be installed without modification to cabinet.
- P** Location of plumbing should be checked prior to installation of storage accessory.
- *** Recommended.
- Not applicable.
- †** Only one tray will fit.
- **** Roll Out Kits also available in white, specify TKIT_ _WH.

TRIM ITEMS WITH RUSTIC CHARACTERISTICS

Product Code	Description	Page #
WFP0330	Wall Filler Pullout Cabinet	70
BFP03	Base Filler Pullout Cabinet	89
MCROWN_	Moulding Crown	159
MICROWN_	Moulding Insert Crown	159
MFOLCR_	Moulding Full Overlay Crown	160
MTCROWN8	Moulding Tall Crown	160
MSHKRCROWN_	Moulding Shaker Crown	160
MBS_	Moulding Base Shoe	163
FBC3X3	Filler - Base Corner	164
F3_ _ & F6_ _	Filler - Base & Tall Straight	164
V_ _ RA & V_ _ _ ST	Valance - Arch & Straight	170
PDWP	Dishwasher Front Panel	172
PEPR335 **	Aristex® End Panel with 3" Stile	172
PEPRPLY_ _ 35 *	Plywood End Panel with 1 1/2" or 3" Stile	172
PREF23_ _	Plywood Refrigerator End Panel	172
PREPRP_ _ _ _ *	Plywood Refrigerator End Panel with 1 1/2" Stile	172
PREPR33096	Veneer Furniture Board Refrigerator End Panel with 3" Stile	172
PP9635	Stock Panel	173
P48_ _	Stock Panel	173
EP_ _ _ _	Veneer End Panel	173

** Rustic characteristics on PEPR335 Filler only.

* Rustic characteristics on PEPRPLY1.535, PREPRP1.584, and PREPRP1.596 panels only.

GLASS SIZE CHART FOR WALL PREPPED FOR GLASS CABINETS

	Butt Doors		Butt Doors		Butt Doors		Butt Doors		Center Mullion Doors		Butt Doors		Butt Doors		Center Mullion Doors	
	Width	Height	Width	Height	Width	Height	Width	Height	Width	Height	Width	Height	Width	Height	Width	Height
	Briardiff Dryden Durham Eastland Wentworth		Ellsworth		Harrison Roxburgh Winstead		Monroe Saybrooke		Benton		Grayson Landen		Ayden Radford		Avalon Oakland Pioneer Sinclair Westbury	
RECOMMENDED GLASS SIZES																
WPG1542	9 5/8"	36 5/8"	10 13/16"	37 13/16"	10 7/8"	37 7/8"	9 1/4"	36 1/4"	9 1/4"	36 1/4"	8 1/8"	35 1/8"	9 5/8"	36 5/8"	9 5/8"	36 5/8"
WPG3042	9 5/8"	36 5/8"	10 13/16"	37 13/16"	10 7/8"	37 7/8"	9 1/4"	36 1/4"	9 1/4"	36 1/4"	8 1/8"	35 1/8"	9 5/8"	36 5/8"	9 5/8"	36 5/8"
WPG3042B	9 13/16"	36 5/8"	11"	37 13/16"	11 1/16"	37 7/8"	9 7/16"	36 1/4"	•	•	9 1/8"	35 1/8"	9 13/16"	36 5/8"	•	•
WPG1842	12 5/8"	36 5/8"	13 13/16"	37 13/16"	13 7/8"	37 7/8"	12 1/4"	36 1/4"	12 1/4"	36 1/4"	11 1/8"	35 1/8"	12 5/8"	36 5/8"	12 5/8"	36 5/8"
WPG3642	12 5/8"	36 5/8"	13 13/16"	37 13/16"	13 7/8"	37 7/8"	12 1/4"	36 1/4"	12 1/4"	36 1/4"	11 1/8"	35 1/8"	12 5/8"	36 5/8"	12 5/8"	36 5/8"
WPG3642B	12 13/16"	36 5/8"	14"	37 13/16"	14 1/16"	37 7/8"	12 7/16"	36 1/4"	•	•	12 1/8"	35 1/8"	12 13/16"	36 5/8"	•	•
WPG2142	15 5/8"	36 5/8"	16 13/16"	37 13/16"	16 7/8"	37 7/8"	15 1/4"	36 1/4"	15 1/4"	36 1/4"	14 1/8"	35 1/8"	15 5/8"	36 5/8"	15 5/8"	36 5/8"
WPG2442	18 5/8"	36 5/8"	19 13/16"	37 13/16"	19 7/8"	37 7/8"	18 1/4"	36 1/4"	18 1/4"	36 1/4"	17 1/8"	35 1/8"	18 5/8"	36 5/8"	18 5/8"	36 5/8"
WPG1536	9 5/8"	30 5/8"	10 13/16"	31 13/16"	10 7/8"	31 7/8"	9 1/4"	30 1/4"	9 1/4"	30 1/4"	8 1/8"	29 1/8"	9 5/8"	30 5/8"	9 5/8"	30 5/8"
WPG3036	9 5/8"	30 5/8"	10 13/16"	31 13/16"	10 7/8"	31 7/8"	9 1/4"	30 1/4"	9 1/4"	30 1/4"	8 1/8"	29 1/8"	9 5/8"	30 5/8"	9 5/8"	30 5/8"
WPG3036B	9 13/16"	30 5/8"	11"	31 13/16"	11 1/16"	31 7/8"	9 7/16"	30 1/4"	•	•	9 1/8"	29 1/8"	9 13/16"	30 5/8"	•	•
WPG1836	12 5/8"	30 5/8"	13 13/16"	31 13/16"	13 7/8"	31 7/8"	12 1/4"	30 1/4"	12 1/4"	30 1/4"	11 1/8"	29 1/8"	12 5/8"	30 5/8"	12 5/8"	30 5/8"
WPG3636	12 5/8"	30 5/8"	13 13/16"	31 13/16"	13 7/8"	31 7/8"	12 1/4"	30 1/4"	12 1/4"	30 1/4"	11 1/8"	29 1/8"	12 5/8"	30 5/8"	12 5/8"	30 5/8"
WPG3636B	12 13/16"	30 5/8"	14"	31 13/16"	14 1/16"	31 7/8"	12 7/16"	30 1/4"	•	•	12 1/8"	29 1/8"	12 13/16"	30 5/8"	•	•
WPG2136	15 5/8"	30 5/8"	16 13/16"	31 13/16"	16 7/8"	31 7/8"	15 1/4"	30 1/4"	15 1/4"	30 1/4"	14 1/8"	30 5/8"	15 5/8"	30 5/8"	15 5/8"	30 5/8"
WPG2436	18 5/8"	30 5/8"	19 13/16"	31 13/16"	19 7/8"	31 7/8"	18 1/4"	30 1/4"	18 1/4"	30 1/4"	17 1/8"	29 1/8"	18 5/8"	30 5/8"	18 5/8"	30 5/8"
WPG1530	9 5/8"	24 5/8"	10 13/16"	25 13/16"	10 7/8"	25 7/8"	9 1/4"	24 1/4"	9 1/4"	24 1/4"	8 1/8"	23 1/8"	9 5/8"	24 5/8"	9 5/8"	24 5/8"
WPG3030	9 5/8"	24 5/8"	10 13/16"	25 13/16"	10 7/8"	25 7/8"	9 1/4"	24 1/4"	9 1/4"	24 1/4"	8 1/8"	23 1/8"	9 5/8"	24 5/8"	9 5/8"	24 5/8"
WPG3030B	9 13/16"	24 5/8"	11"	25 13/16"	11 1/16"	25 7/8"	9 7/16"	24 1/4"	•	•	9 1/8"	23 1/8"	9 13/16"	24 5/8"	•	•
WPG1830	12 5/8"	24 5/8"	13 13/16"	25 13/16"	13 7/8"	25 7/8"	12 1/4"	24 1/4"	12 1/4"	24 1/4"	11 1/8"	23 1/8"	12 5/8"	24 5/8"	12 5/8"	24 5/8"
WPG3630	12 5/8"	24 5/8"	13 13/16"	25 13/16"	13 7/8"	25 7/8"	12 1/4"	24 1/4"	12 1/4"	24 1/4"	11 1/8"	23 1/8"	12 5/8"	24 5/8"	12 5/8"	24 5/8"
WPG3630B	12 13/16"	24 5/8"	14"	25 13/16"	14 1/16"	25 7/8"	12 7/16"	24 1/4"	•	•	12 1/8"	23 1/8"	12 13/16"	24 5/8"	•	•
WPG2130	15 5/8"	24 5/8"	16 13/16"	25 13/16"	16 7/8"	25 7/8"	15 1/4"	24 1/4"	15 1/4"	24 1/4"	14 1/8"	23 1/8"	15 5/8"	24 5/8"	15 5/8"	24 5/8"
WPG2430	18 5/8"	24 5/8"	19 13/16"	25 13/16"	19 7/8"	25 7/8"	18 1/4"	24 1/4"	18 1/4"	24 1/4"	17 1/8"	23 1/8"	18 5/8"	24 5/8"	18 5/8"	24 5/8"
WPG3024	9 5/8"	18 5/8"	10 13/16"	19 13/16"	10 7/8"	19 7/8"	9 1/4"	18 1/4"	9 1/4"	18 1/4"	8 1/8"	17 1/8"	9 5/8"	18 5/8"	9 5/8"	18 5/8"
WPG3024B	9 13/16"	18 5/8"	11"	19 13/16"	11 1/16"	19 7/8"	9 7/16"	18 1/4"	•	•	9 1/8"	17 1/8"	9 13/16"	18 5/8"	•	•
PWPG3024	9 5/8"	18 5/8"	10 13/16"	19 13/16"	10 7/8"	19 7/8"	9 1/4"	18 1/4"	9 1/4"	18 1/4"	8 1/8"	17 1/8"	9 5/8"	18 5/8"	9 5/8"	18 5/8"
PWPG3024B	9 13/16"	18 5/8"	11"	19 13/16"	11 1/16"	19 7/8"	9 7/16"	18 1/4"	•	•	9 1/8"	17 1/8"	9 13/16"	18 5/8"	•	•
WPG3624	12 5/8"	18 5/8"	13 13/16"	19 13/16"	13 7/8"	19 7/8"	12 1/4"	18 1/4"	12 1/4"	18 1/4"	11 1/8"	17 1/8"	12 5/8"	18 5/8"	12 5/8"	18 5/8"
WPG3624B	12 13/16"	18 5/8"	14"	19 13/16"	14 1/16"	19 7/8"	12 7/16"	18 1/4"	•	•	12 1/8"	17 1/8"	12 13/16"	18 5/8"	•	•
PWPG3624	12 5/8"	18 5/8"	13 13/16"	19 13/16"	13 7/8"	19 7/8"	12 1/4"	18 1/4"	12 1/4"	18 1/4"	11 1/8"	17 1/8"	12 5/8"	18 5/8"	12 5/8"	18 5/8"
PWPG3624B	12 13/16"	18 5/8"	14"	19 13/16"	14 1/16"	19 7/8"	12 7/16"	18 1/4"	•	•	12 1/8"	17 1/8"	12 13/16"	18 5/8"	•	•
DCPG2442	9 5/8"	36 5/8"	10 13/16"	37 13/16"	10 7/8"	37 7/8"	9 1/4"	36 1/4"	9 1/4"	36 1/4"	11 1/8"	35 1/8"	12 5/8"	36 5/8"	12 5/8"	36 5/8"
DCPG2742	9 5/8"	36 5/8"	10 13/16"	37 13/16"	10 7/8"	37 7/8"	9 1/4"	36 1/4"	9 1/4"	36 1/4"	11 1/8"	35 1/8"	12 5/8"	36 5/8"	12 5/8"	36 5/8"
DCPG2436	9 5/8"	30 5/8"	10 13/16"	31 13/16"	10 7/8"	31 7/8"	9 1/4"	30 1/4"	9 1/4"	30 1/4"	11 1/8"	29 1/8"	12 5/8"	30 5/8"	12 5/8"	30 5/8"
DCPG2736	9 5/8"	30 5/8"	10 13/16"	31 13/16"	10 7/8"	31 7/8"	9 1/4"	30 1/4"	9 1/4"	30 1/4"	11 1/8"	29 1/8"	12 5/8"	30 5/8"	12 5/8"	30 5/8"
DCPG2430	9 5/8"	24 5/8"	10 13/16"	25 13/16"	10 7/8"	25 7/8"	9 1/4"	24 1/4"	9 1/4"	24 1/4"	11 1/8"	23 1/8"	12 5/8"	24 5/8"	12 5/8"	24 5/8"

► Nantucket, Augusta, and Teagan are not available in Wall Prepped for Glass cabinets.

HARDWARE CHART

NOTES ✓

- ▶ Screws included with hardware.
- ▶ Order under style #010.
- ▶ Hardware is recommended for use on all full overlay and miter door styles (except Avalon and Radford). All other door styles have a reverse bevel and hardware is not required.
- ★ Hardware does not fit certain Briarcliff, Durham, Nantucket, and Wentworth drawers because of small width of recessed center drawer panel.



	PRODUCT CODE	Item Description	Finish/Color	Drill Center
	H112	Knob	Black Chrome	N/A
	H167	Knob	Polished Brass Plated	N/A
	H300	Knob	Patina Black	N/A
	H302 ★	Pull	Patina Black	4"
	H303	Knob	Patina Black	N/A
	H304 ★	Pull	Patina Rouge	4"
	H305	Knob	Patina Rouge	N/A
	H307	Knob	Patina Rouge	N/A
	H308 ★	Pull 5 1/16"	German Bronze	128mm
	H310	Round Knob 1 1/4"	German Bronze	N/A
	H311 ★	Pull 5 1/16"	Antique Pewter	128mm
	H312 ★	Cup Pull 2 1/2"	Antique Pewter	64mm
	H313	Round Knob 1 1/4"	Antique Pewter	N/A
	H314 ★	Pull	Brushed Satin Nickel	96mm

HARDWARE CHART

	PRODUCT CODE	Item Description	Finish/Color	Drill Center
	H315 *	Pull	Brushed Satin Nickel	128mm
	H316	Round Knob 1 1/4"	Brushed Satin Nickel	N/A
	H317	Knob 1 1/4"	Polished Chrome	N/A
	H318 *	Pull	Flat Black	128mm
	H319	Large Flower Twist Knob	Pewter	N/A
	H320 *	Twist Wire Drop Handle	Pewter	5"
	H322	Knob	Nouveau White	N/A
	H323	Round Knob 1 1/4"	Flat Black	N/A
	H332	Pull	Brushed Satin Nickel	4"
	H333 *	Pull	Venetian Bronze	4"
	H334 *	Knob	Venetian Bronze	N/A
	H335	Birdcage Pull	Pewter	4"
	H336	Pull 5"	Venetian Bronze	128 mm
	H337	Birdcage Pull	Venetian Bronze	4"

NOTES ✓









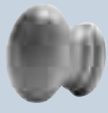

- ▶ Screws included with hardware.
- ▶ Order under style #010.
- ▶ Hardware is recommended for use on all full overlay and miter door styles (except Avalon and Radford). All other door styles have a reverse bevel and hardware is not required.

*Hardware does not fit certain Briarcliff, Durham, Nantucket, and Wentworth drawers because of small width of recessed center drawer panel.



Continued on next page.

HARDWARE CHART

	PRODUCT CODE	Item Description	Finish/Color	Drill Center
	H338	Pull	Black Chrome	4"
	H339	Birdcage Knob	Venetian Bronze	N/A
	H340	Knob	Venetian Bronze	N/A
	H341	Maple Knob	Standard Finishes Order under Maple finish style numbers: Saddle 170, Rouge 180, Natural 182, Autumn 183, Fawn 197, or Sarsaparilla 193	N/A
	H342	Oak Knob	Standard Finishes Order under Oak finish style numbers: Saddle 171, Spice 185, Wheat 186, or Natural 188	N/A
	New H343 *	Pull	Brushed Satin Nickel	128mm
	New H344	Pull	Brushed Satin Nickel	96mm
	New H345	Knob	Brushed Satin Nickel	N/A
	New H346	Pull	Brushed Satin Nickel	96mm
	New H347	Pull	Brushed Satin Nickel	3"
	New H348	Knob	Brushed Satin Nickel	1"

NOTES ✓

- ▶ Screws included with hardware.
- ▶ Order under style #010 with exception of Maple and Oak Knobs.
- ▶ Hardware is recommended for use on all full overlay and miter door styles (except Avalon and Radford). All other door styles have a reverse bevel and hardware is not required.
- ★Hardware does not fit certain Briarcliff, Durham, Nantucket, and Wentworth drawers because of small width of recessed center drawer panel.

